



INVERTED BUCKET STEAM TRAPS IB12

DESCRIPTION

The IB12 is a series of general purpose robust and versatile inverted bucket steam traps manufactured in SG iron. These steam traps operate intermittently and are suitable for use with saturated or superheated steam. Typical applications include drip points, steam tracing lines, dryers, chemical and laundry equipment.

MAIN FEATURES

Intermittent discharge.
Discharges condensate at steam temperature.
Unaffected by water hammer and vibrations.
Easy to maintain.

USE: Saturated and superheated steam.

AVAILABLE MODELS: IB12-4, 8 and 12 – SG iron.

SIZES: 1/2" to 3/4" – DN 15 to DN 20.

CONNECTIONS: Female threaded ISO 7 Rp or NPT.
Screw-on flanges EN 1092-2 PN 16/40.
Screw-on flanges ASME B16.42 Class 150.

INSTALLATION: Horizontal installation.
See IMI – Installation and maintenance instructions.

MAX. ΔP: IB12-4 – 4 bar
IB12-8 – 8 bar
IB12-12 – 12 bar



CE MARKING – GROUP 2 (PED – European Directive)

PN 16	Category
1/2" to 3/4" – DN 15 to 20	SEP

BODY LIMITING CONDITIONS	
THREADED / SCREW-ON FLANGED ALLOWABLE PRESSURE	RELATED TEMPERATURE
16 bar	100 °C
15,5 bar	150 °C
14,7 bar	200 °C
13,9 bar	250 °C

PMO – Max. operating pressure: 14 bar.
TMO – Max. operating temperature: 198 °C.

FLOW RATE CAPACITY (kg/h)												
MODEL	SIZE	DIFFERENTIAL PRESSURE (bar)										
		1	2	3	4	5	6	7	8	10	11	12
IB12-4	1/2" to 3/4" DN 15 to 20	280	390	470	530	–	–	–	–	–	–	–
IB12-8	1/2" to 3/4" DN 15 to 20	190	260	320	360	400	430	460	500	–	–	–
IB12-12	1/2" to 3/4" DN 15 to 20	160	220	260	290	320	360	370	400	440	480	490

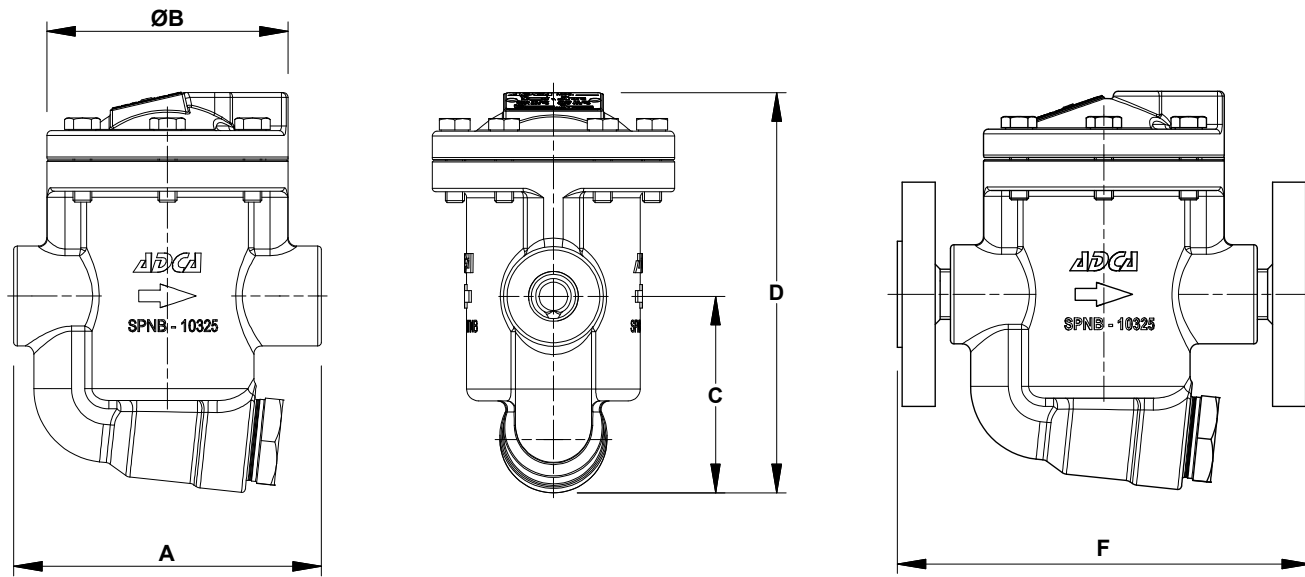

DIMENSIONS (mm)									
THREADED						PN 16/40		CLASS 150	
SIZE	A	B	C	D	WEIGHT (kg)	F *	WEIGHT (kg)	F *	WEIGHT (kg)
1/2" – DN 15	130	102	83	168	3,9	175	5,3	175	4,7
3/4" – DN 20	130	102	83	168	3,9	175	5,8	175	5

* With screw-on flanges.

MATERIALS		
POS. N°	DESIGNATION	MATERIAL
1	Body	GJS-400-15 / 0.7040
2	Cover	GJS-400-15 / 0.7040
3	* Gasket	Stainless steel / Graphite
4	* Seat	AISI 410 / 1.4006
5	* Valve	AISI 410 / 1.4006
6	* Lever	AISI 304 / 1.4301
7	* Bucket	AISI 304 / 1.4301
8	* Strainer screen	AISI 304 / 1.4301
9	Gasket	Stainless steel / Graphite
10	Plug	A105 / 1.0432
11	Bolts	Steel 8.8

* Available spare parts.

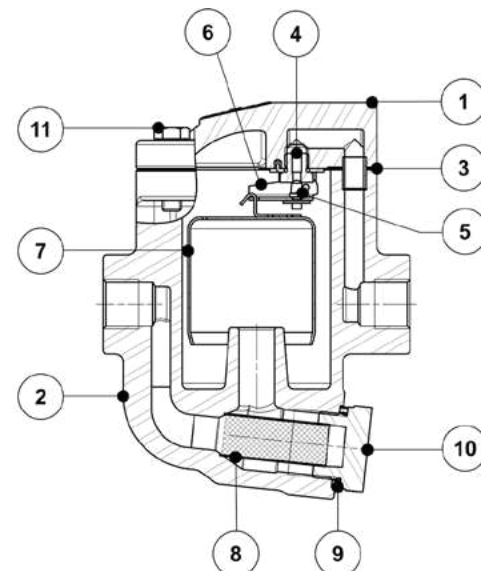

INVERTED BUCKET STEAM TRAPS IBB12

DESCRIPTION

The IBB12 is a series of general purpose robust and versatile inverted bucket steam traps manufactured in SG iron. These steam traps operate intermittently and are suitable for use with saturated or superheated steam. Typical applications include drip points, steam tracing lines, dryers, chemical and laundry equipment.

MAIN FEATURES

Intermittent discharge.
Discharges condensate at steam temperature.
Unaffected by water hammer and vibrations.
Easy to maintain.

USE: Saturated and superheated steam.

AVAILABLE MODELS: IBB12-4, 8 and 12 – SG iron.

SIZES: 3/4" to 1" – DN 20 to DN 25.

CONNECTIONS: Female threaded ISO 7 Rp or NPT.
Screw-on flanges EN 1092-2 PN 16/40.
Screw-on flanges ASME B16.42 Class 150.

INSTALLATION: Horizontal installation.
See IMI – Installation and maintenance instructions.

MAX. ΔP: IBB12-4 – 4 bar
IBB12-8 – 8 bar
IBB12-12 – 12 bar



CE MARKING – GROUP 2 (PED – European Directive)

PN 16	Category
3/4" to 1" – DN 20 to 25	SEP

BODY LIMITING CONDITIONS

THREADED / SCREW-ON FLANGED ALLOWABLE PRESSURE	RELATED TEMPERATURE
16 bar	100 °C
15,5 bar	150 °C
14,7 bar	200 °C
13,9 bar	250 °C

PMO – Max. operating pressure: 14 bar.
TMO – Max. operating temperature: 198 °C.

FLOW RATE CAPACITY (kg/h)

MODEL	SIZE	DIFFERENTIAL PRESSURE (bar)										
		1	2	3	4	5	6	7	8	10	11	12
IBB12-4	3/4" to 1" DN 20 to 25	1090	1340	1550	1670	–	–	–	–	–	–	–
IBB12-8	3/4" to 1" DN 20 to 25	725	910	1030	1100	1160	1210	1250	1290	–	–	–
IBB12-12	3/4" to 1" DN 20 to 25	570	720	810	860	920	950	985	1010	1060	1080	1100

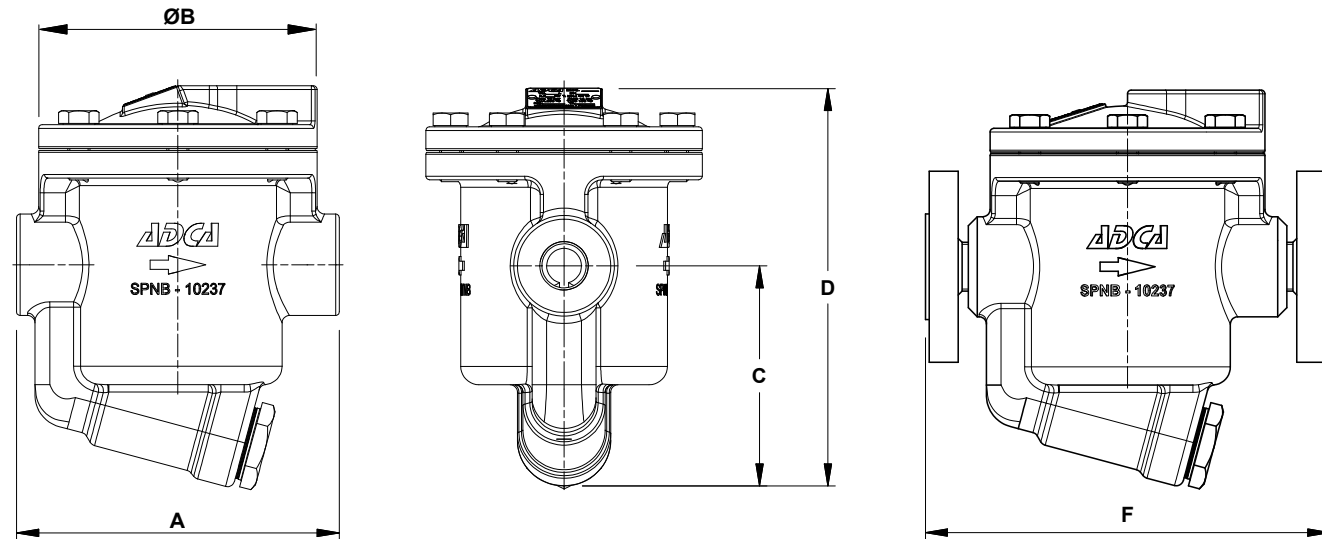

DIMENSIONS (mm)									
THREADED						PN 16/40		CLASS 150	
SIZE	A	B	C	D	WEIGHT (kg)	F *	WEIGHT (kg)	F *	WEIGHT (kg)
3/4" – DN 20	175	151	120	217	9,4	222	11,2	222	10,4
1" – DN 25	175	151	120	217	9,3	222	11,5	222	10,8

* With screw-on flanges.

MATERIALS		
POS. N°	DESIGNATION	MATERIAL
1	Body	GJS-400-15 / 0.7040
2	Cover	GJS-400-15 / 0.7040
3	* Gasket	Stainless steel / Graphite
4	* Seat	AISI 410 / 1.4006
5	* Valve	AISI 410 / 1.4006
6	* Lever	AISI 304 / 1.4301
7	* Bucket	AISI 304 / 1.4301
8	* Strainer screen	AISI 304 / 1.4301
9	Gasket	Stainless steel / Graphite
10	Plug	A105 / 1.0432
11	Bolts	Steel 8.8

* Available spare parts.

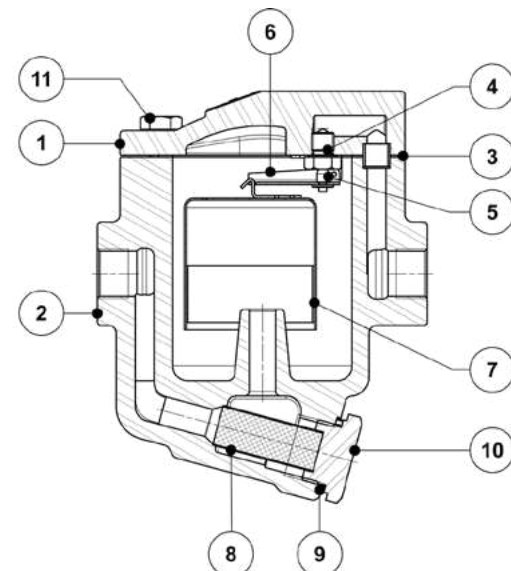

INVERTED BUCKET STEAM TRAPS IB30S

DESCRIPTION

The IB30S is a series of general purpose robust and versatile inverted bucket steam traps manufactured in carbon steel. These steam traps operate intermittently and are suitable for use with saturated or superheated steam. Typical applications include drip points, steam tracing lines, dryers, chemical and laundry equipment.

MAIN FEATURES

Intermittent discharge.
Discharges condensate at steam temperature.
Unaffected by water hammer and vibrations.
Robust and versatile.
Easy to maintain.



OPTIONS: BDV – Blowdown valve.
AFZ – Anti-freeze device.

USE: Saturated and superheated steam.

AVAILABLE MODELS: IB30S-4, 8, 12 and 17 – carbon steel.

SIZES: 1/2" to 1".

CONNECTIONS: Female threaded ISO 7 Rp or NPT.
Socket weld (SW) ASME 16.11.
Butt weld (BW) ASME B16.25 on request.

INSTALLATION: Horizontal installation.
See IMI – Installation and maintenance instructions.

MAX. ΔP: IB30S-4 – 4 bar
IB30S-8 – 8 bar
IB30S-12 – 12 bar
IB30S-17 – 17 bar

CE MARKING – GROUP 2 (PED – European Directive)

PN 25	Category
1/2" to 1"	SEP

BODY LIMITING CONDITIONS *	
ALLOWABLE PRESSURE	RELATED TEMPERATURE
25 bar	100 °C
25 bar	200 °C
24,4 bar	250 °C
22 bar	300 °C

PMO – Maximum operating pressure: 17 bar.
TMO – Maximum operating temperature: 300 °C.
* According to EN 1092-1:2018.

FLOW RATE CAPACITY (kg/h)

MODEL	SIZE	DIFFERENTIAL PRESSURE (bar)													
		1	2	3	4	5	6	7	8	10	11	12	14	17	
IB30S-4	1/2" to 1"	280	390	470	530	–	–	–	–	–	–	–	–	–	–
IB30S-8	1/2" to 1"	190	260	320	360	400	430	460	500	–	–	–	–	–	
IB30S-12	1/2" to 1"	160	220	260	290	320	360	370	400	440	480	490	–	–	
IB30S-17	1/2" to 1"	140	180	200	215	225	235	240	250	265	270	275	280	400	

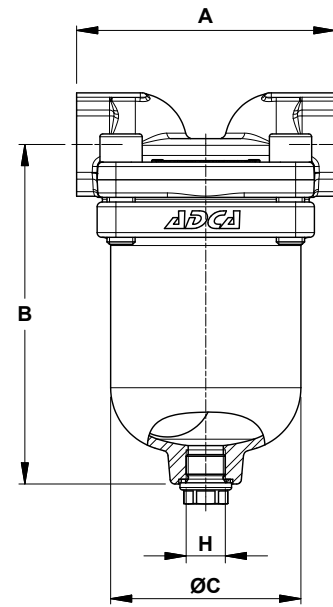

DIMENSIONS (mm)					
SIZE	A	B	ØC	H	WEIGHT (kg)
1/2"	110	144	81	3/8"	3,4
3/4"	110	144	81	3/8"	3,3
1"	110	144	81	3/8"	3,2

* As standard, in versions with female Rp threads, this connection is female threaded ISO 7 Rp. In versions with female NPT threads or SW, this connection is female threaded NPT.

MATERIALS		
POS. N°	DESIGNATION	MATERIAL
1	Body	A216 WCB / 1.0619
2	Cover	A216 WCB / 1.0619
3	* Gasket	Stainless steel / Graphite
4	* Seat	AISI 410 / 1.4006
5	* Valve	AISI 410 / 1.4006
6	* Lever	AISI 304 / 1.4301
7	* Bucket	AISI 304 / 1.4301
8	Inlet tube	AISI 304 / 1.4301
9	Bolts	Steel 8.8
10	Plug	AISI 316 / 1.4401
11	** Washer	Copper; AISI 304 / 1.4301
51	Blowdown valve	AISI 303 / 1.4305; AISI 316L / 1.4404
61	Anti-freeze device	AISI 303 / 1.4305; AISI 316L / 1.4404

* Available spare parts; ** Not applicable in NPT version.

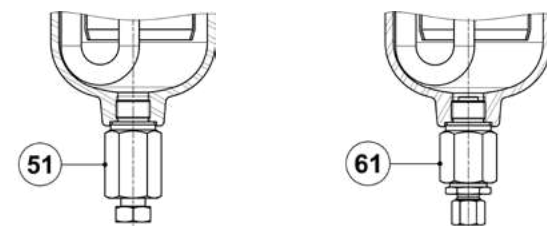
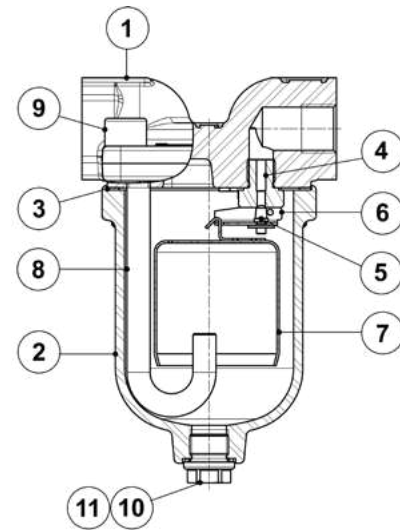

BDV - Blowdown valve
(Manual)

AFZ - Anti-freeze device
(Automatic)

We reserve the right to change the design and material of this product without notice.

IS IB30S.015 E 00.22

INVERTED BUCKET STEAM TRAPS IB30SS

DESCRIPTION

The IB30SS is a series of general purpose robust and versatile inverted bucket steam traps manufactured in stainless steel. These steam traps operate intermittently and are suitable for use with saturated or superheated steam. Typical applications include drip points, steam tracing lines, dryers, chemical and laundry equipment.

MAIN FEATURES

Intermittent discharge.
Discharges condensate at steam temperature.
Unaffected by water hammer and vibrations.
Robust and versatile.
Easy to maintain.

OPTIONS: BDV – Blowdown valve.
AFZ – Anti-freeze device.

USE: Saturated and superheated steam.

AVAILABLE MODELS: IB30SS-4, 8, 12 and 17 – stainless steel.

SIZES: 1/2" to 1".

CONNECTIONS: Female threaded ISO 7 Rp or NPT.
Socket weld (SW) ASME 16.11.
Butt weld (BW) ASME B16.25 on request.

INSTALLATION: Horizontal installation.
See IMI – Installation and maintenance instructions.

MAX. ΔP: IB30SS-4 – 4 bar
IB30SS-8 – 8 bar
IB30SS-12 – 12 bar
IB30SS-17 – 17 bar

CE MARKING – GROUP 2 (PED – European Directive)

PN 25	Category
1/2" to 1"	SEP



BODY LIMITING CONDITIONS *	
ALLOWABLE PRESSURE	RELATED TEMPERATURE
25 bar	100 °C
21 bar	200 °C
18,5 bar	350 °C
17,1 bar	400 °C

PMO – Maximum operating pressure: 17 bar.
TMO – Maximum operating temperature: 400 °C.
* According to EN 1092-1:2018.

		FLOW RATE CAPACITY (kg/h)													
MODEL	SIZE	DIFFERENTIAL PRESSURE (bar)													
		1	2	3	4	5	6	7	8	10	11	12	14	17	
IB30SS-4	1/2" to 1"	280	390	470	530	–	–	–	–	–	–	–	–	–	–
IB30SS-8	1/2" to 1"	190	260	320	360	400	430	460	500	–	–	–	–	–	–
IB30SS-12	1/2" to 1"	160	220	260	290	320	360	370	400	440	480	490	–	–	–
IB30SS-17	1/2" to 1"	140	180	200	215	225	235	240	250	265	270	275	280	400	–

We reserve the right to change the design and material of this product without notice.

IS IB30SS.015 E 00.21

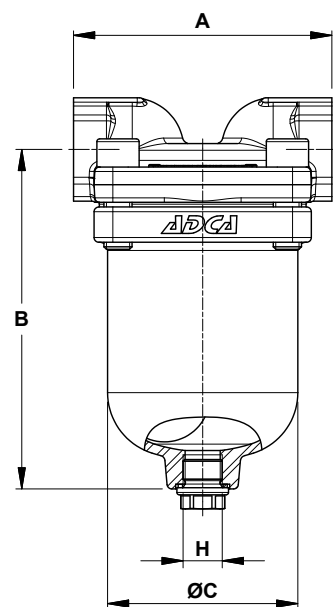

DIMENSIONS (mm)					
SIZE	A	B	ØC	H	WEIGHT (kg)
1/2"	110	144	81	3/8"	3,4
3/4"	110	144	81	3/8"	3,3
1"	110	144	81	3/8"	3,2

* As standard, in versions with female Rp threads, this connection is female threaded ISO 7 Rp. In versions with female NPT threads or SW, this connection is female threaded NPT.

MATERIALS		
POS. N°	DESIGNATION	MATERIAL
1	Body	AISI 316L / 1.4404
2	Cover	A351 CF8M / 1.4408
3	* Gasket	Stainless steel / Graphite
4	* Seat	AISI 410 / 1.4006
5	* Valve	AISI 410 / 1.4006
6	* Lever	AISI 304 / 1.4301
7	* Bucket	AISI 304 / 1.4301
8	Inlet tube	AISI 304 / 1.4301
9	Bolts	Stainless steel A2-70
10	Plug	AISI 316 / 1.4401
11	** Washer	Copper; AISI 304 / 1.4301
51	Blowdown valve	AISI 303 / 1.4305; AISI 316L / 1.4404
61	Anti-freeze device	AISI 303 / 1.4305; AISI 316L / 1.4404

* Available spare parts; ** Not applicable in NPT version.

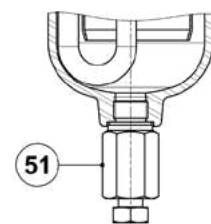
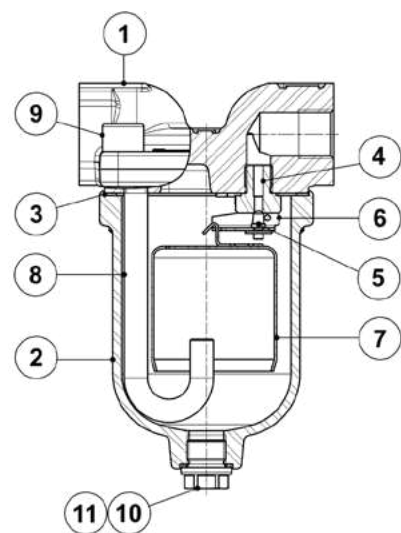

BDV - Blowdown valve
(Manual)

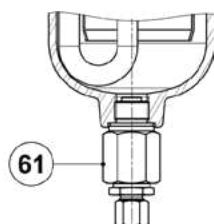

AFZ - Anti-freeze device
(Automatic)

INVERTED BUCKET STEAM TRAPS IB30 (1 1/2" – 2"; DN 40 – DN 50)

DESCRIPTION

The IB30 series inverted bucket steam traps are recommended for applications where the most important requirements are overall operating efficiency and long, trouble-free service life. They operate intermittently, either wide open or tightly closed and are, therefore, best suited for medium and high steam pressure applications.

MAIN FEATURES

Intermittent discharge.
Discharges condensate at steam temperature.
Unaffected by water hammer and vibrations.
Easy to maintain.

USE: Saturated and superheated steam.

AVAILABLE MODELS: IB30S-4, 8 and 12 – carbon steel.

SIZES: 1 1/2" to 2"; DN 40 to DN 50.

CONNECTIONS: Female threaded ISO 7 Rp or NPT.
Flanged EN 1092-1 PN 25
Flanged ASME B16.5 Class 150 or 300.
Socket weld (SW) ASME 16.11.
Butt weld (BW) ASME B16.25 on request.

INSTALLATION: Vertical installation.
See IMI – Installation and maintenance instructions.

MAX. ΔP: IB30S-4 – 4 bar
IB30S-8 – 8 bar
IB30S-12 – 12 bar

CE MARKING – GROUP 2 (PED – European Directive)

PN 25	Category
1 1/2" to 2" DN 40 to 50	1 (CE marked)



BODY LIMITING CONDITIONS		
FLANGED PN 25 / CLASS 300 *	FLANGED CLASS 150 **	RELATED TEMPERATURE
ALLOWABLE PRESSURE	ALLOWABLE PRESSURE	
23,2 bar	15,4 bar	100 °C
20,8 bar	13,8 bar	200 °C
19 bar	12,1 bar	250 °C
17,2 bar	10,2 bar	300 °C

PMO – Maximum operating pressure: 17 bar;
TMO – Maximum operating temperature: 220 °C.
* Acc. to EN 1092-1:2018; ** Acc. to EN 1759-1:2004.
Body limiting conditions PN 25 or below, depending on the type of connection adopted. Rating PN 25 for threaded, SW and BW versions.

FLOW RATE CAPACITY (kg/h)

MODEL	SIZE	DIFFERENTIAL PRESSURE (bar)											
		1	2	3	4	5	6	7	8	10	11	12	
IB30S-4	1 1/2" to 2" DN 40 to 50	2200	2770	3220	3570	–	–	–	–	–	–	–	–
IB30S-8	1 1/2" to 2" DN 40 to 50	1850	2200	2560	2800	3070	3300	3500	3700	–	–	–	–
IB30S-12	1 1/2" to 2" DN 40 to 50	1150	1500	1720	1880	2050	2200	2325	2470	2670	2820	2900	–

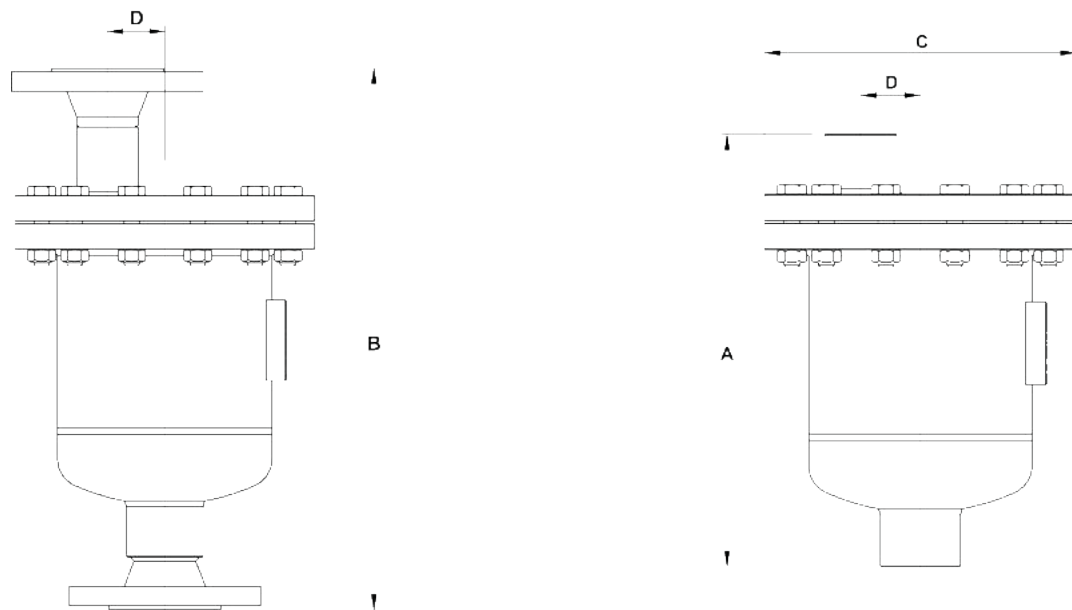

DIMENSIONS (mm)										
THREADED / SW				PN 25		CLASS 150		CLASS 300		
SIZE	A	C	D	WEIGHT (kg)	B	WEIGHT (kg)	B	WEIGHT (kg)	B	WEIGHT (kg)
1 1/2" – DN 40	330	235	45	17,5	425	21,6	442	21,3	448	23,4
2" – DN 50	338	235	45	18	428	23,5	444	23,6	450	24,9

MATERIALS		
POS. N°	DESIGNATION	MATERIAL
1	Body	S355JR / 1.0045
2	Cover	P235GH / 1.0345
3	* Gasket	Graphite
4	* Seat	AISI 420 / 1.4021
5	* Valve	AISI 420 / 1.4021
6	* Lever	AISI 304 / 1.4301
7	* Bucket	AISI 304 / 1.4301
8	Inlet tube	P235GH / 1.0345
9	Bolts	Steel 8.8

* Available spare parts.

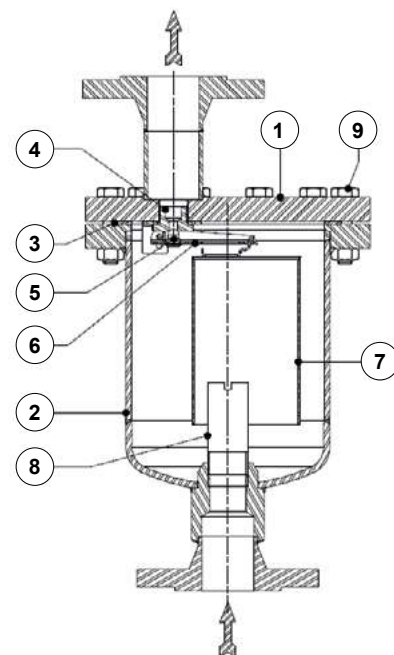

INVERTED BUCKET STEAM TRAPS IB36S

DESCRIPTION

The IB36S is a series of robust and versatile inverted bucket steam traps manufactured in carbon steel. These steam traps operate intermittently, and are suitable for use with low to high pressure saturated or superheated steam. Typical applications include drip points, steam tracing lines, dryers, chemical and laundry equipment.

MAIN FEATURES

Intermittent discharge.
Discharges condensate at steam temperature.
Unaffected by water hammer and vibrations.
Robust and versatile.
Easy to maintain.

OPTIONS: BDV – Blowdown valve.
AFZ – Anti-freeze device.

USE: Saturated and superheated steam.

AVAILABLE MODELS: IB36S-5, 10, 15, 30 and 40 – carbon steel.

SIZES: 1/2" to 1"; DN 15 to DN 25.

CONNECTIONS: Female threaded ISO 7 Rp or NPT.
Flanged EN 1092-1 PN 40.
Flanged ASME B16.5 Class 150 or 300.
Socket weld (SW) ASME B16.11.
Butt weld (BW) ASME B16.25 on request.

INSTALLATION: Horizontal installation.
See IMI – Installation and maintenance instructions.

MAX. ΔP: IB36S-5 – 5 bar
IB36S-10 – 10 bar
IB36S-15 – 15 bar
IB36S-30 – 30 bar
IB36S-40 – 40 bar

CE MARKING – GROUP 2
(PED – European Directive)

PN 40	Category
1/2" to 1" – DN 15 to 25	SEP

FLOW RATE CAPACITY (kg/h)

MODEL	SIZE	DIFFERENTIAL PRESSURE (bar)														
		1	2	3	4	5	6	7	8	9	10	15	20	30	40	
IB36S-5	1/2" to 1" – DN 15 to 25	290	400	495	550	610	–	–	–	–	–	–	–	–	–	–
IB36S-10	1/2" to 1" – DN 15 to 25	225	300	350	395	420	470	490	520	540	560	–	–	–	–	–
IB36S-15	1/2" to 1" – DN 15 to 25	190	255	295	330	370	390	410	445	465	490	520	–	–	–	–
IB36S-30	1/2" to 1" – DN 15 to 25	130	180	210	225	265	285	300	315	340	355	415	450	480	–	–
IB36S-40	1/2" to 1" – DN 15 to 25	90	120	135	155	165	185	205	220	230	245	290	320	370	400	–



BODY LIMITING CONDITIONS

FLANGED CLASS 300 / THREADED / BW / SW **	FLANGED PN 40 *	FLANGED CLASS 150 **	RELAT. TEMP.
ALLOWABLE PRESSURE	ALLOW. PRESS.	ALLOW. PRESS.	
50 bar	40 bar	19,3 bar	50 °C
46,3 bar	37,1 bar	17,7 bar	100 °C
43,9 bar	33,3 bar ***	14 bar ***	200 °C
41,6 bar ***	30,4 bar	12,1 bar	250 °C
38,9 bar	27,6 bar	10,2 bar	300 °C
34,6 bar	23,8 bar	6,5 bar	400 °C

* According to EN 1092-1:2018.

** According to EN 1759-1:2004.

*** PMO – Maximum operating pressure.

TMO – Maximum operating temperature: 400 °C.

Body limiting conditions Class 300 or below, depending on the type of connection adopted. Rating Class 300 for threaded, SW and BW versions.

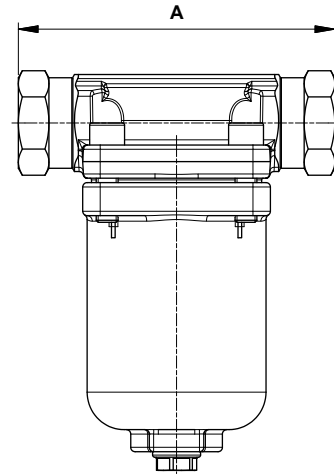
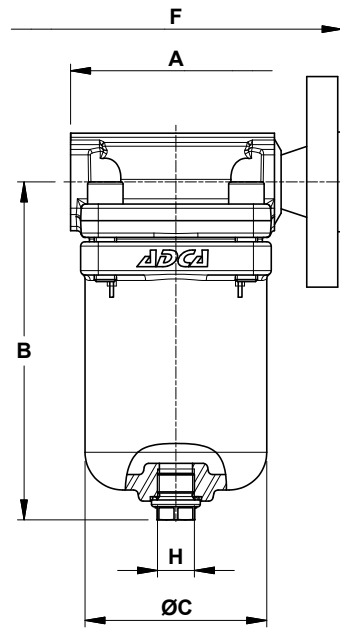

Only for 1" threaded version
(with welded coupling)

DIMENSIONS (mm)

SIZE	THREADED					SW		PN 40		CLASS 150		CLASS 300	
	A	B	ØC	H *	WEIGHT (kg)	A	WEIGHT (kg)	F	WEIGHT (kg)	F	WEIGHT (kg)	F	WEIGHT (kg)
1/2" – DN 15	95	153	82	3/8"	3,9	95	3,9	150	5,4	150	4,8	150	5,3
3/4" – DN 20	95	153	82	3/8"	3,8	95	3,8	150	5,9	150	5,2	150	6,2
1" – DN 25	145 **	153	82	3/8"	4	95	3,8	160	6,3	160	5,7	160	6,8

* As standard, in versions with EN flanges or female Rp threads, this connection is female threaded ISO 7 Rp. In versions with ASME flanges, female NPT threads or SW, this connection is female threaded NPT.

** With welded coupling.

MATERIALS

POS. Nº	DESIGNATION	MATERIAL
1	Body	P250GH / 1.0460
2	Cover	A216 WCB / 1.0619
3	* Gasket	Stainless steel / Graphite
4	* Seat	AISI 440C / 1.4125
5	* Valve	AISI 420 / 1.4021
6	* Lever	AISI 304 / 1.4301
7	* Bucket	AISI 304 / 1.4301
8	Inlet tube	AISI 316L / 1.4404
9	Bolts	ASTMA193 Gr. B7
10	Plug	AISI 316 / 1.4401
11	** Washer	Copper; AISI 304 / 1.4301
51	Blowdown valve	AISI 303 / 1.4305; AISI 316L / 1.4404
61	Anti-freeze device	AISI 303 / 1.4305; AISI 316L / 1.4404

* Available spare parts; ** Not applicable in NPT version.

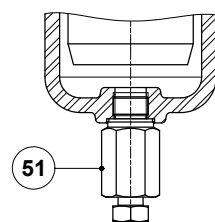
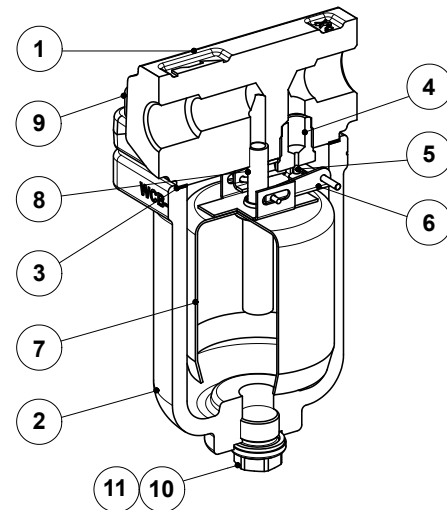

BDV - Blowdown valve
(Manual)

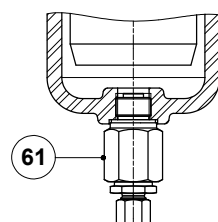

AFZ - Anti-freeze device
(Automatic)

We reserve the right to change the design and material of this product without notice.

IS IB36S.015 E 01.21

**INVERTED BUCKET STEAM TRAPS
IB36i**

DESCRIPTION

The IB36i is a series of robust and versatile inverted bucket steam traps manufactured in stainless steel. These steam traps operate intermittently, and are suitable for use with low to high pressure saturated or superheated steam. Typical applications include drip points, steam tracing lines, dryers, chemical and laundry equipment.

MAIN FEATURES

Intermittent discharge.
Discharges condensate at steam temperature.
Unaffected by water hammer and vibrations.
Robust and versatile.
Easy to maintain.

OPTIONS: BDV – Blowdown valve.
AFZ – Anti-freeze device.

USE: Saturated and superheated steam.

AVAILABLE MODELS: IB36i-5, 10, 15 and 27 – stainless steel.

SIZES: 1/2" to 1"; DN 15 to DN 25.

CONNECTIONS: Female threaded ISO 7 Rp or NPT.
Flanged EN 1092-1 PN 40.
Flanged ASME B16.5 Class 150 or 300.
Socket weld (SW) ASME B16.11.
Butt weld (BW) ASME B16.25 on request.

INSTALLATION: Horizontal installation.
See IMI – Installation and maintenance instructions.

MAX. ΔP: IB36i-5 – 5 bar
IB36i-10 – 10 bar
IB36i-15 – 15 bar
IB36i-27 – 27 bar

**CE MARKING – GROUP 2
(PED – European Directive)**

PN 40	Category
1/2" to 1" – DN 15 to 25	SEP

FLOW RATE CAPACITY (kg/h)

MODEL	SIZE	DIFFERENTIAL PRESSURE (bar)													
		1	2	3	4	5	6	7	8	9	10	15	20	27	
IB36i-5	1/2" to 1" – DN 15 to 25	290	400	495	550	610	–	–	–	–	–	–	–	–	–
IB36i-10	1/2" to 1" – DN 15 to 25	225	300	350	395	420	470	490	520	540	560	–	–	–	–
IB36i-15	1/2" to 1" – DN 15 to 25	190	255	295	330	370	390	410	445	465	490	520	–	–	–
IB36i-27	1/2" to 1" – DN 15 to 25	130	180	210	225	265	285	300	315	340	355	415	450	470	–

We reserve the right to change the design and material of this product without notice.

IS IB36i.015 E 00.21



BODY LIMITING CONDITIONS		
FLANGED PN 40 / CLASS 300 ALLOWABLE PRESSURE	FLANGED CLASS 150 * ALLOWABLE PRESSURE	RELATED TEMP.
37 bar	15,3 bar	50 °C
30 bar	13,3 bar	100 °C
28,8 bar	11,1 bar **	200 °C
26,6 bar **	10,2 bar	250 °C
25,2 bar	9,7 bar	300 °C
23,1 bar	6,5 bar	400 °C

* According to EN 1759-1:2004.
** PMO – Maximum operating pressure.
TMO – Maximum operating temperature: 400 °C.
Body limiting conditions PN 40 or below, depending on the type of connection adopted. Rating PN 40 for threaded, SW and BW versions.

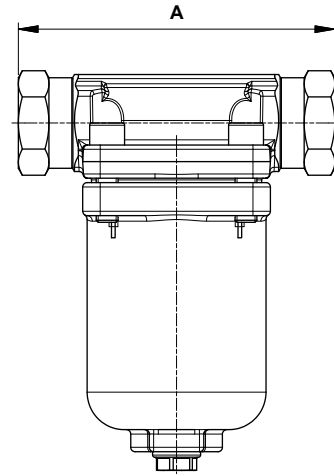
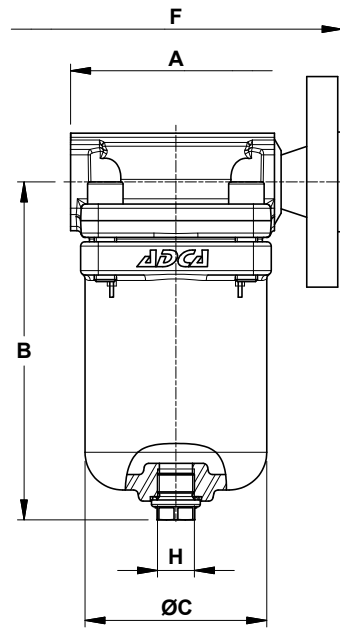

Only for 1" threaded version
(with welded coupling)

DIMENSIONS (mm)													
THREADED						SW		PN 40		CLASS 150		CLASS 300	
SIZE	A	B	ØC	H *	WEIGHT (kg)	A	WEIGHT (kg)	F	WEIGHT (kg)	F	WEIGHT (kg)	F	WEIGHT (kg)
1/2" – DN 15	95	153	82	3/8"	3,9	95	3,9	150	5,4	150	4,8	150	5,3
3/4" – DN 20	95	153	82	3/8"	3,8	95	3,8	150	5,9	150	5,2	150	6,2
1" – DN 25	145 **	153	82	3/8"	4	95	3,8	160	6,3	160	5,7	160	6,8

* As standard, in versions with EN flanges or female Rp threads, this connection is female threaded ISO 7 Rp. In versions with ASME flanges, female NPT threads or SW, this connection is female threaded NPT.

** With welded coupling.

MATERIALS		
POS. N°	DESIGNATION	MATERIAL
1	Body	AISI 316L / 1.4404
2	Cover	A351 CF8M / 1.4408
3	* Gasket	Stainless steel / Graphite
4	* Seat	AISI 440C / 1.4125
5	* Valve	AISI 420 / 1.4021
6	* Lever	AISI 304 / 1.4301
7	* Bucket	AISI 304 / 1.4301
8	Inlet tube	AISI 316L / 1.4404
9	Bolts	Stainless steel A2-70
10	Plug	AISI 316 / 1.4401
11	** Washer	Copper; AISI 304 / 1.4301
51	Blowdown valve	AISI 303 / 1.4305; AISI 316L / 1.4404
61	Anti-freeze device	AISI 303 / 1.4305; AISI 316L / 1.4404

* Available spare parts; ** Not applicable in NPT version.

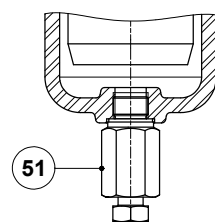
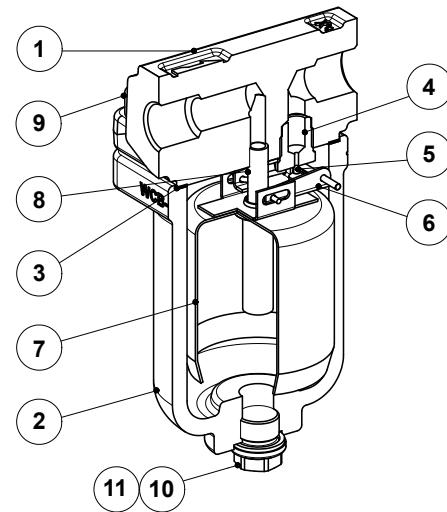

BDV - Blowdown valve
(Manual)

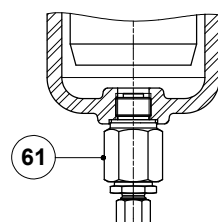

AFZ - Anti-freeze device
(Automatic)